

# BB-4<sup>®</sup>

## SERIES

### BB-4-18P

PORTABLE



#### HIGH PRESSURE 4-STAGE FIRE PUMP

The **WATERAX** BB-4-18 pump pairs a reliable high performance 4-stage pump end with a powerful Briggs & Stratton 4-stroke 18 HP engine to achieve pressures of up to **440 PSI (30.3 BAR)** and flow rates reaching **104 GPM (394 L/Min)**. Strong enough to operate as a source pump for tandem and parallel pumping, it is also optimal for direct attack firefighting, remote watering, sprinkler systems, and is a popular choice for slip-on units.

The **WATERAX** quick release clamp provided on the BB-4<sup>®</sup> pump lets you replace a damaged pump end in the field with minimal equipment downtime. The 4-stage pump end on the BB-4<sup>®</sup> is identical to the pump end on the MARK-3<sup>®</sup> unit, which greatly reduces your spare parts inventory and improves your ability to respond to unforeseen equipment damage. You can also quickly install a mid-range B2X<sup>™</sup> pump end as needed for supply or structure firefighting.

#### Applications

- Slip-on units
- Attack line firefighting
- Long hose lay for remote watering during firefighting operations
- High elevation firefighting in mountainous areas
- Accuracy in flow trajectory when structure firefighting
- Tandem pumping over long distances
- Parallel pumping for higher volumes

#### Features and Benefits

- Quick release clamp and swappable pump ends for minimal equipment downtime and inventory
- Sealed bearing to eliminate pump end greasing in the field
- Belt drive system for reliable, low maintenance performance
- Aluminium alloy pump components and anodized parts for lighter weight and greater resistance to corrosion
- Comprehensive user and service manuals
- EPA Certified

### SPECIFICATIONS

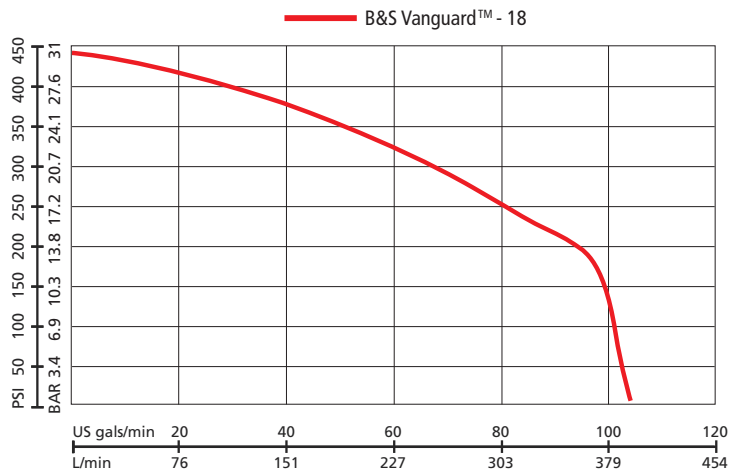

### Flow rate at specified pressure

Maximum Pressure: 440 PSI (30.3 bar)  
 Free flow: 104 US gals/min (394 L/min)  
 Maximum Head: 1016' (310 m)

Flow Rate			Pressure	
US GPM	( LPM )	@	PSI	( BAR )
100	( 379 )	@	150	( 10.3 )
80	( 303 )	@	250	( 17.2 )
50	( 189 )	@	350	( 24.1 )

Engine: Briggs & Stratton® Vanguard™ - 18 hp



### Pump Specifications:

Type: Detachable 4 stage Centrifugal  
 Ratings: ISO 9 and NFPA 1906 Medium Pressure Rating of 50 GPM  
 Description: High Pressure, Medium Flow, Foam Compatible  
 Maximum Allowable Pressure: 600 PSI (41.4 bar)  
 Intake: 2" Male NPSH Thread  
 Discharge: Check Valve: 1-1/2" male NPSH thread (meets US Forest Service Specification 5100-382)  
 Priming Port: 1-1/2" Male NPSH Thread  
 Body & Diffusers: Anodized corrosive resistant aluminum  
 Impellers: 3.67" Diameter; Anodized corrosive resistant aluminum  
 Pump Shaft: Stainless Steel  
 Bearings: Maintenance Free; sealed ball bearing  
 Pump Seal: Heat resistant, Maintenance Free  
 Clamp: Hand tight quick release clamp (no tools needed)  
 Drive Unit: Timing Belt and Pulley; Speed Increaser  
 Speed Increaser Position: Vertical  
 Drive Ratio: 1.88: 1  
 Color: Red  
 Special Feature: The entire pump separates completely from the engine/speed increaser.

### Engine Specifications:

Model & Type: Briggs and Stratton Vanguard 4-cycle, horizontal shaft, twin cylinder, OHV  
 Maximum Power: 18 HP (13.4 kW) @ 4000 RPM  
 Maximum Torque: 26.9 lb-ft (36.5 Nm) @ 2800 RPM  
 Bore & Stroke: 2.83 x 2.76 inches (72 x 70 mm)  
 Displacement: 34.78 cubic inches (570 cc)  
 Starting System: Re-coil start with 12 VDC electric start option  
 Ignition: Magnatron  
 Charging: 16 AMP regulating alternator  
 Governor: Mechanical  
 Cooling: Air Cooled  
 Lubrication: Oil, Full pressure  
 Oil Capacity: 1.8 quarts (1.7 liters)  
 Fuel Pump: 18 inch lift.  
 Emissions: Meets current CARB, EPA, and CE requirements.  
 Fuel Type: Gasoline [unleaded, 86 minimum octane, 10% maximum ethanol]  
 Fuel Consumption: 1.6 US gals/hr (6.1 liters/hr)  
 Optional Integrated Fuel Tank Option: 7 US quarts (6.6 liters) with manual shut off valve  
 Muffler: Forestry approved spark arrestor

## SPECIFICATIONS

### Primer Specifications:

#### Hand Primer Option:

	Guzzler, Diaphragm Type; Reliable, Lightweight and Rugged
Intake and Discharge Port Size:	½" Female NPT
Construction:	Aluminum Handle, composite body, buna-n reinforced diaphragm and flapper valves
Lift:	12 feet (3.7 m) [up to approximately 16 feet (4.8 m) with suction hose footvalve]
Head Capacity:	30 ft (9.1 m)
Maximum Pressure:	15 PSI (1.03 bar)
Maximum Service Temp:	150° F (66° C)
Volume per Stroke:	0.44 quart (0.42 liter)
Dimensions (L x W x H):	12-¾" x 4-½" x 4-5/16" (324 x 114 x 110 mm)
Weight:	1.70 lbs (0.77 kg)
	Shipped loose with connection hardware and 6 feet of hose

#### Exhaust Primer Option:

	Venturi Type (when selected mounted to exhaust primer muffler)
Venturi Construction:	Brass
Exhaust Valve Construction:	Aluminum with stainless shaft and disc
Operation:	Remote mount push/pull cable.
Vacuum:	Minimum of 17 in-Hg

#### Electric Primer Option:

	12 VDC Piston Type Vacuum Pump
Intake and Discharge Port Size:	¾" Female NPT
Construction:	Corrosion Resistant Aluminum with Bronze Sleeve and Composite Piston
Max. Current Draw:	105 amps
Lift:	25 feet (7.6 m)
Vacuum:	22 in-Hg
Dimensions:	9" x 4-1/8" x 7-1/2" (229 x 105 x 191 mm)
Weight:	8.1 lbs (3.7 kg)
Vehicle Units:	Shipped loose with mounting plate, hardware, and 6 feet of hose

### Frame Specifications:

Color:	Black
Finish:	Powder Coat
Handles:	Tubular U-shaped integrated into the base frame

### Controls Specifications:

#### Briggs & Stratton Standard Engine Controls:

Start/Stop:	Turn-key rotary switch
Throttle:	Lever control on left side of blower housing
Choke:	Push/pull ring pin located on starter side of the engine below the air filter housing.

#### Engine Mount Control Panel:

On/Off Switch:	Weather resistant chrome toggle switch
Start:	Weather resistant push button switch (with battery kit option only)
Throttle:	Vernier with red push button emergency throttle idle
Low Oil Pressure Warning:	Red LED (with battery kit option only)
Choke:	Push/pull ring pin located on starter side of the engine below the air filter housing.

### Discharge Gauge Specifications:

0 to 600 PSI Dual unit (PSI/kilopascals) liquid filled; Pump mounted.

**PRODUCT SELECTION**

**PRODUCT SELECTION MATRIX**

			BB-4-18P	BB-4-18PTC	BB-4-18PXTC	BB-4-18PETC
<b>STANDARD INCLUSIONS</b>	Primer	Guzzler Hand Primer	S	S	-	-
		Remote Exhaust Primer w/Control Cable PART-763	-	-	-	-
		Exhaust Primer	-	-	-	S
		Electric Package - Electric Primer, LED work light, & Battery	-	-	-	S
	Muffler	B&S horizontal low tone	-	-	-	-
		Dual B&S low tone	S	S	S	-
		Exhaust primer muffler	-	-	-	S
	Fuel Tank	Integral / 7 US qts (6.6 L)	-	S	S	S
		Integral / 4 US qts (3.8 L) w/ 3-way valve	-	-	-	-
	Controls	Engine Mount Control Panel	-	S	S	S
	Discharge Gauge	0-600 psi, 2-1/2" dial	S	S	S	S
	Check Valve Manifold	1-1/2" NPSH	S	S	S	S
	FastWire CTRL Cable	B&S 3' CTRL Cable with 8 pin connector (FWC-B-3)	-	-	-	-
Weight		167 lbs (76 kg)	172 lbs (78 kg)	176 lbs (80 kg)	194 lbs (88 kg)	

**OPTIONS & ACCESSORIES**

**Sold Separately**

**Electric Kit**



**BATKIT-20-P**  
Battery Kit 12V 20ah, Portable



**WLIGHTKIT**  
LED Work Light w/ 5' harness & toggle switch

**Fuel Tank & Fuel Line**



**FA-452**  
Remote Fuel Tank  
6.6 US Gallons w/ quick conn.

**FA-452-3**  
Remote Fuel Tank  
3.2 US Gallons w/ quick conn.

**12-401B-NS-TRPD**  
Fuel Line EPA -  
quick conn. to hose 1/4"

**12-401B-NS-TRPD**  
Fuel Line -  
quick conn. to SAE 45 Flare

**Pump Intake & Discharge Adapters**



- ADP-A-FM20S** Adapter 2" NPSH Female to NPSH Male
- ADP-A-FM20SP** Adapter 2" NPSH Female to NPT Male
- ADP-A-FM20SV** Adapter 2" NPSH Female to Victaulic
- ADP-A-FM15SN** Adapter 1-1/2" NPSH Female to NH Male
- ADP-A-FM15S** Adapter 1-1/2" NPSH Female to NPSH Male
- ADP-A-FM15SP** Adapter 1-1/2" NPSH Female to NPT Male
- ADP-A-FM15SV** Adapter 1-1/2" NPSH Female to Victaulic



**B-6365**  
Check valve manifold 1-1/2" NPSH

### TECHNICAL DRAWINGS

**BB-4-18P** Length 35" (88.9 cm) Width 19.75" (50.16 cm) Height 20.5" (52.07 cm) Weight 167 lbs (76 kg)

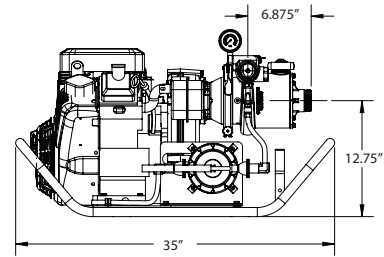
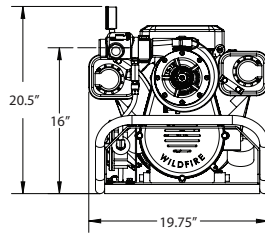
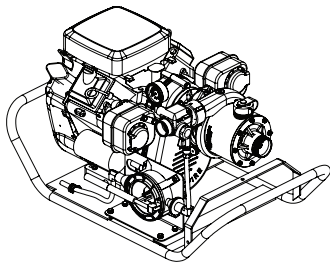

**BB-4-18PTC** Length 35" (88.9 cm) Width 19.75" (50.16 cm) Height 22.5" (57.15 cm) Weight 172 lbs (78 kg)

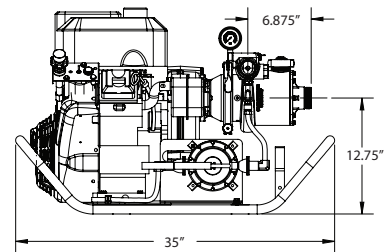
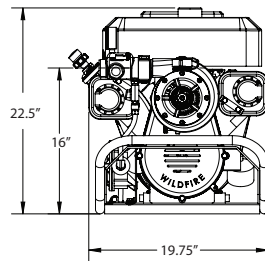
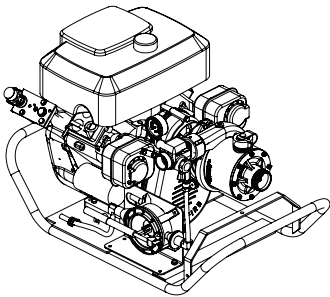

**BB-4-18PXTC** Length 35" (88.9 cm) Width 24" (60.96 cm) Height 22.5" (57.15 cm) Weight 176 lbs (80 kg)

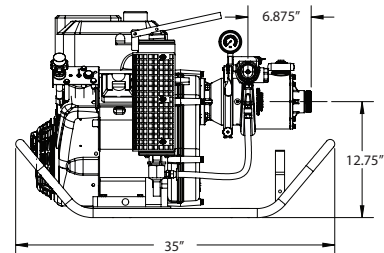
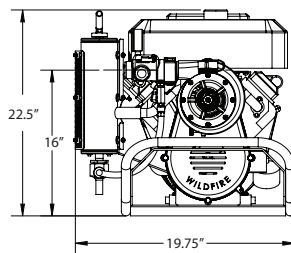
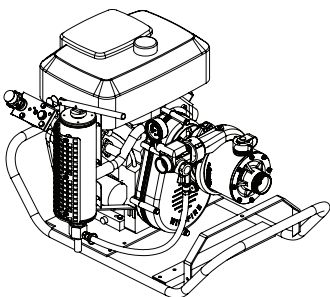

**BB-4-18PETC** Length 35" (88.9 cm) Width 22" (55.88 cm) Height 23.25" (59.05 cm) Weight 194 lbs (88 kg)

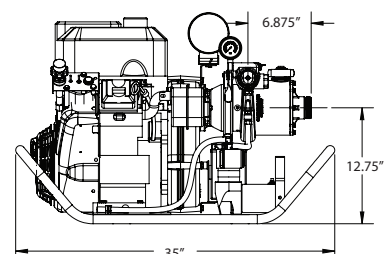
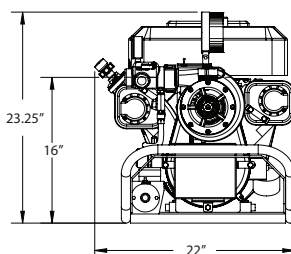
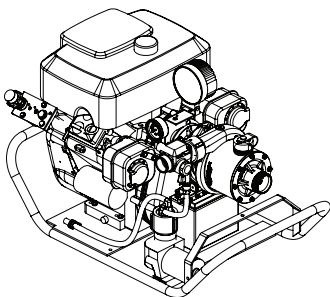



**WATERAX Inc.**  
6635 Henri-Bourassa W.  
Montreal, QC H4R 1E1

**TF 855-616-1818**

**T** 514-637-1818

**F** 514-637-3985

info@waterax.com  
www.waterax.com

Distributed by:

All information contained in this document including drawings is proprietary to *WATERAX* and may not be copied, reproduced or used in whole or in part without our prior written permission. The information in this document is subject to change without notice. Model displayed with multiple options. Weight and dimensions are approximated and may vary depending on options.